



# **Eastman** EXPORTS (P) LTD.

An IATF:16949-2016 Certified Company

Forgings

Machining

Fabrication

Sand Castings

High-Pressure Die Castings

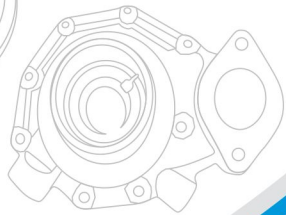
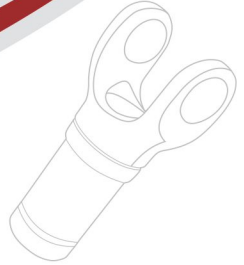
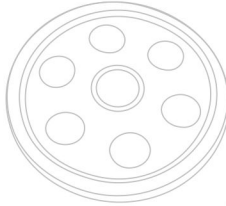

## OUR PROFILE

Eastman Exports (P) Ltd. an IATF 16949:2016 & ISO 9001:2015 (TUV SUD certified) company, is a leading manufacturer and exporter of Machined Forged, Machined Casted, Ring rolling, Bar turned, Light & Heavy fabricated components with an annual turn over of USD 72 millions. We are graded suppliers to OEM & Tire-1 companies over 60 countries across the globe. Our stringent quality norms, price sensitivity & timely deliveries has been a key to our success in this business. Constant upgradation of technology and infusion of resources has enabled us to maintain leadership in this globally competitive market.

Eastman Exports (P) Ltd. has JVR FORGINGS LTD. as its Forging, Ring Rolling & Machining Unit, Eastman Impex Mfg. as its Machining, Light & Heavy Fabrication unit & BDNJ Castings as its SG & CI casting unit serving variety of customers catering to Agriculture, Automotive, Off highway, Constructions, Railways, Mining & white goods industries.



## JVR FORGINGS LIMITED

JVR forging Ltd. is as ISO/TS 16949:2008 , ISO14001:2004,ISO 9001:2008 TUV SUD certified plant, truly dedicated to the production of Forging, Ring rolling & Machined products.

### PRODUCTION FACILITY

Forging	: 1.25Ton, 1.5Ton, 2Ton & 3Ton Drop Hammers with Induction Billet Heaters (Capacity 1000T / Per Month).
Forging Presses	: 1600Ton & 2500Ton Forging Presses (Capacity 350T / Per Month).
Ring Rolling	: Two Lines for Ring Dia 60 to 360mm.(Capacity 300T / Per Month).
Hi-Tech Machining	: CNC Turning Centre, VMC, HMC etc.
Conventional Machines	: Broaching, Radial Drilling, Milling, Centerless & Surface Grinder & SPM's (Turning & Milling)...etc.
Heat Treatment	: CNC Induction Hardening (Low & Medium Frequency). PLC Controlled Conveyors Furnace for Normalizing, Hardening, Tempering & Isothermal Annealing. Electrical Pit Furnace for Gas & Case Carburizing.
Quality Testing Lab	: In house facility for all type of Mechanical, Chemical & Physical Testings which includes Spectrometer, UTM, Microscopic testing, Hardness test, Impact test, CMM etc.
Tool Room	: VMC, Wirecut Machine, Grinders & Planer etc.

Eastman Impex Manufacturing is an IATF 16949:2016 & ISO 9001:2015 TUV SUD Certified & has welding certifications EN 1090-2 & ISO 3834 from SLV Mannheim, Germany.

Dedicated to the productions of Precise Machining of Forgings, Castings, Bar Turned, Aluminium PDC parts, Light & Heavy Fabrications.

#### PRODUCTION FACILITY

- Hi-Tech Machining : CNC turning centres, VMC & HMC capable of machining products with high accuracy.
- Conventional Machines : SPM's (Turning & Milling), Centreless and Surface grinders etc.
- Fabrication : All types of machines for light and heavy sheet metal / fabricated parts which includes power presses plasma cutting, laser cutting, shearing presses, break presses, MIG welding & Robotic Welding Machines.
- Surface Treatment : 7 Tank Hot Phosphating, Dip & Spray Painting & Hot Dip Galvanizing
- Quality Testing Lab : In house facility for all type of Physical, Chemical, Mechanical & Corrosion resistance testing.
- Tool Room : VMC, Wire cut machine etc.



BDJN Castings is an ISO 9001:2015 TUV SUD Certified plant, engaged in production of SG & Cast Iron Castings.

#### PRODUCT FACILITY

- Molding Line : Sinto High Pressure  
Box Size : 500x400 mm  
Molding Rate : 100 Molds/Hr.
- Furnaces : Inductotherm with Capacity 500 Kg, 2 No. of Ports
- Sand Plant : Automated Sinto Sand Plant with Capacity of 10 Tons/Hr.  
Dead Clay Removal System & Sand Mixer Capacity of 500 Kg
- Quality Testing Lab : Spectrometer, UTM (Mechanical Testing), Metallurgical Testing Microscope, Hardness Tester, Ferro Lab etc.



## OUR CAPABILITIES

### • Design & Development

Eastman Exports (P) Ltd. is using state of art technologies as a part of our quality policy. The use of latest softwares like Pro/E, SOLID WORKS, IDEA & CATIA during the part design makes us possible to attain maximum productivity & creativity from the product definition to the product in the application.

Simulation softwares like DEFORM for forging process & MAGMA for the casting process enables us to obtain better production & design cycles. Integrating simulation & modeling into the design process insure the safe & high quality production.

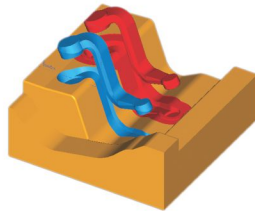
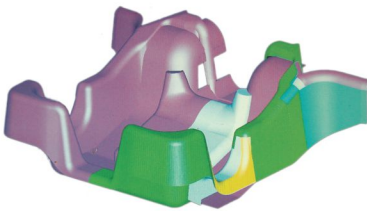

### • Hi-Tech Machining

In our manufacturing units we have complete set up of Conventional & CNC machines which are of make like HAAS, MAKINO, MAZAK etc. Our CNC Turning Centers, VMC & HMC (Vertical & Horizontal Machining Centers) are capable of machining in very precise tolerances. Our stringent quality norms help us to cater all type of Industries like Automotive, Agriculture, Electrical, Off Highway & Railways. Based on the criticality of the products we can also go for complete tooling up machining fixtures.

For Heavy Fabrication we are having Laser Cutting make TRUMF and Plasma Cutting make ADOR, Submerged Arc Welding, TIG, MIG Welding & Robotic Welding which gives us an edge over the competitors.

In addition to the machining set up we have trained team of skilled professionals to generate precise results which are further verified on instruments like CMM, Profile Projectors etc.





## • Heat Treatment

Our PLC controlled heat treatment plants ensures consistent metallurgical properties through Normalizing, Tempering, Hardening, Iso thermal Annealing, Case Carburizing with water, oil or polymer quenching.

We have CNC Controlled Induction Hardening (Low & Medium Frequency) & Case Hardening on products as per customer requirements.

Post heat treatment process includes Shot blasting, Cold coining. After Heat Treatment, Components pass through MPI before being sent for Machining. We are having in-house labs for analyzing the metallurgical properties achieved after heat treatment.

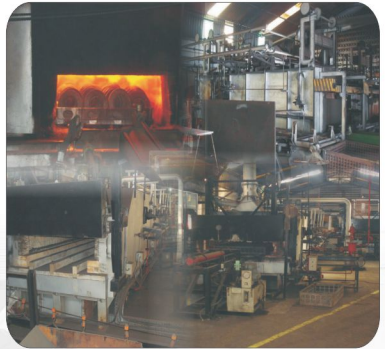

## • Quality Assurance

Through the learning from ACMA UNIDO project and coveted an IATF16949 has imbibed and institutionalized the spirit of TQM at all ranks. Strict quality norms and immediate action on any potential non-conformance are the part of daily work management. Daily monitoring and employee participation through quality circle has ensured consistent conformance of products year after year.

The norms for incoming material, the preliminary test, in process inspection and predispatch inspection are aligned with the Customer Specific Requirements. We are having in-house labs for all types of Non Destructive & Destructive testing which includes Spectrometer, UTM, CMM, Surface Roughness, Coating Thickness & Salt Spray Testing apparatus. The Quality Management System approval by almost all the leading OEMs are testimony to the efforts put in all the team members

Our quality assurance system is continuously audited by our customers such as ZF, CONCENTRIC, EICHER, BORG WARNER, WABCO, TATA MOTORS, RANE TRW, CASE NEW HOLLAND, SKF, HALDEX...etc.



IATF 16949:2016



ISO 9001:2015



ISO 14001:2004



EN 1090-2

## OUR PRODUCT RANGE

### • Forged Machined

#### Products :

Steering Arms, Shaft Stub, Bush, Gear Shifters Forks, Long & Small Yokes, Flange & Splined Yokes, Rings Cross, Pitman Arms, Tie Rods, Control Arms, Steering or Suspension Knuckles, Machined Rings, Gear Blanks, Track Links, Shafts & Bearing Parts.

#### Assemblies :

Propellor Shafts, Rocker Arms Assemblies, Bearings assemblies, Brake Assemblies etc.



### • Ferrous Castings

#### Products :

Water Pump Housing, Pulley, Clutch Housings, Hubs, Callipers, Brake Drums, Brake Discs, Suspension Arms, Brackets, Flywheels, Bearing Cover, Stator Motor Parts, Pumps & Alternator Parts, Intake & Wheel Cylinders, Fuel Injection Housing, Feed Pump Housing, Pipe Fittings, Valve Bodies, Turbo Charger & Super Charger Parts.

#### Assemblies :

Pump assemblies.

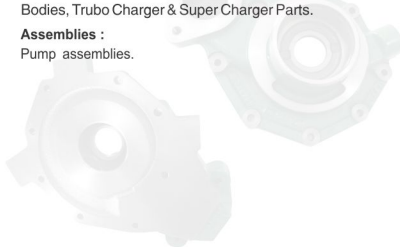

• **Fabrication / Pressed Steel**

**Products :**

Heavy & Light products for Railways and constructions like Door, Troff, Head Stock, Bogie Frame, End Wall, Body Blaster, Bogie Blaster, Couplers, Clamps, Props, Walk board, Frame etc.

**Assemblies:**

Bogie Assembly, Wall Assembly for Railways, Railway Doors etc.

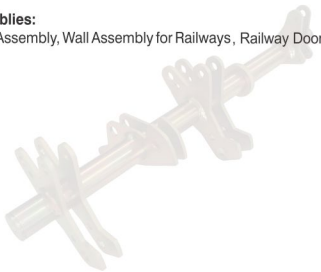

• **Others Products**

**Bar turned :**

Various type of shafts, Thread plugs, Linkage pins, Drive Shafts, spacer, Engine parts , Aluminium turned parts etc.

**Aluminium Die Castings :**

Oil Tank, Alternator cover, Cylinder head cover, Stator Motor & Pump Housings, Brackets, Engine cover parts, Brake parts etc.





Our Group Companies :

 **Eastman** IMPEX

 **JVR FORGINGS LIMITED**

 **BDJN CASTINGS**

Industrial Area-C, Sua Road, Dhandari kalan, Ludhiana-141 010 (INDIA)

Phone : +91-161-5244000, 2511602-603

Fax No. : +91-161-2511600, 5021715

E-mail : sales1@eastmanauto.in

mktg@eastmanauto.in

Website : www.eastmanauto.in